

DM65: wireless dimmer for resistive and infrared heaters. Dimming from 0% to 100%. Input for external wired push-button and wired/wireless PIR sensors. Automatic temperature control through external temperature probe. "Soft start": extending the lifetime of the Infrared heaters.

Technical specifications



- **Power supply:** 230V~ (32A)
 - **Max output power:** 6500W (28A)
 - **Fuse protection:** 32A (FWC high-speed, 10x38 mm)
 - **Operating temperature range:** -20°C / +30°C
 - **Reception frequency:** 868.3 MHz
 - **Dimensions:** 200 x 195 x 75 mm
 - **Protection class:** IP54
- **The maximum number of transmitters that can be memorized is 42.**

Product description

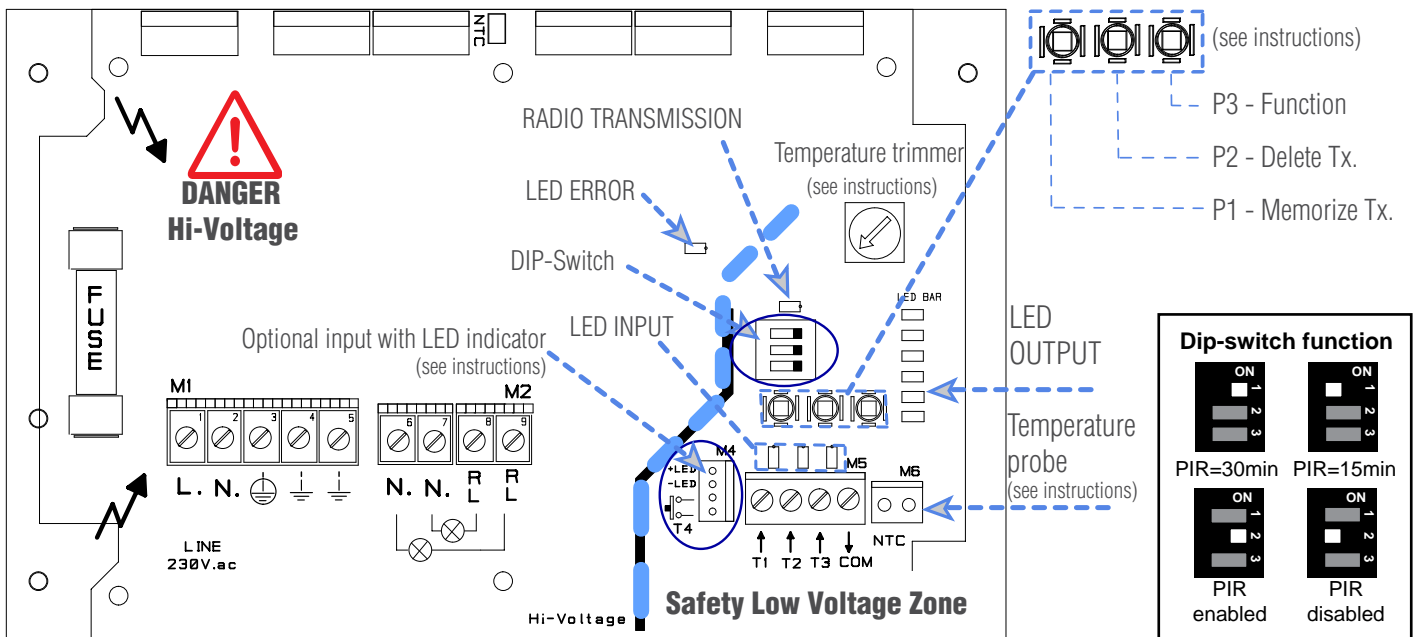

Warnings: High voltage board, risk of electric shock!
Never touch the board outside the safety low voltage zone.

Safety Low Voltage Input

- T1: ON/OFF and DIM the load
Short impulse = ON/OFF
Long impulse = Dim+, Dim-
- T2: PIR Input (ON at 100%)

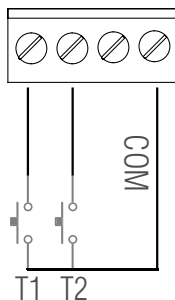

LED	STATUS
ERROR	Fix = Overload Blinking = Overtemperature
INPUT	ON = ACTIVE
RADIO	Blinking = radio trasmission received
OUTPUT	Output level

Wiring Diagrams

• One heater

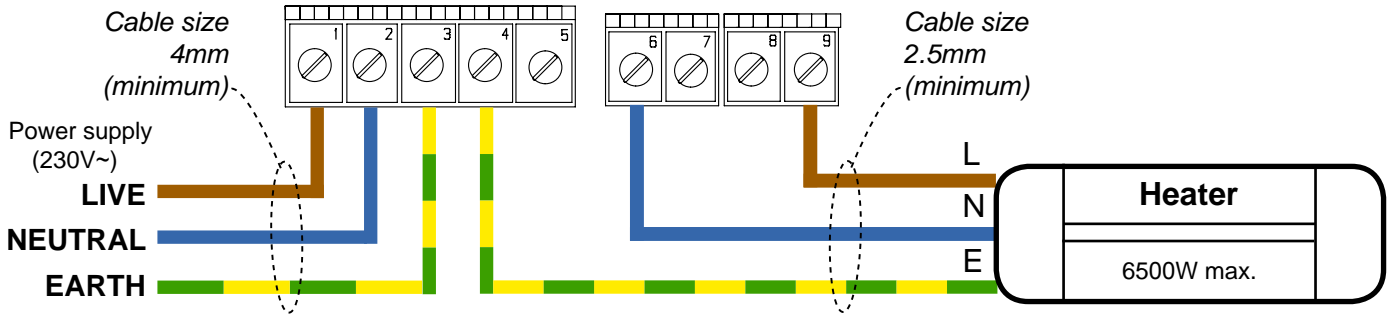

• Two heaters

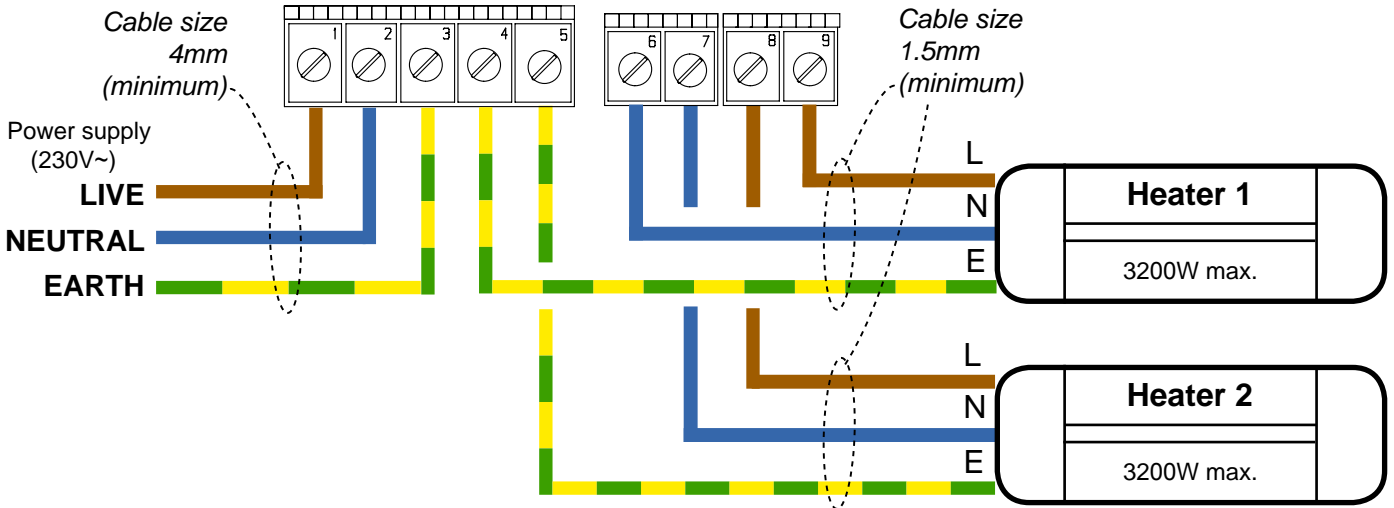

• Four heaters

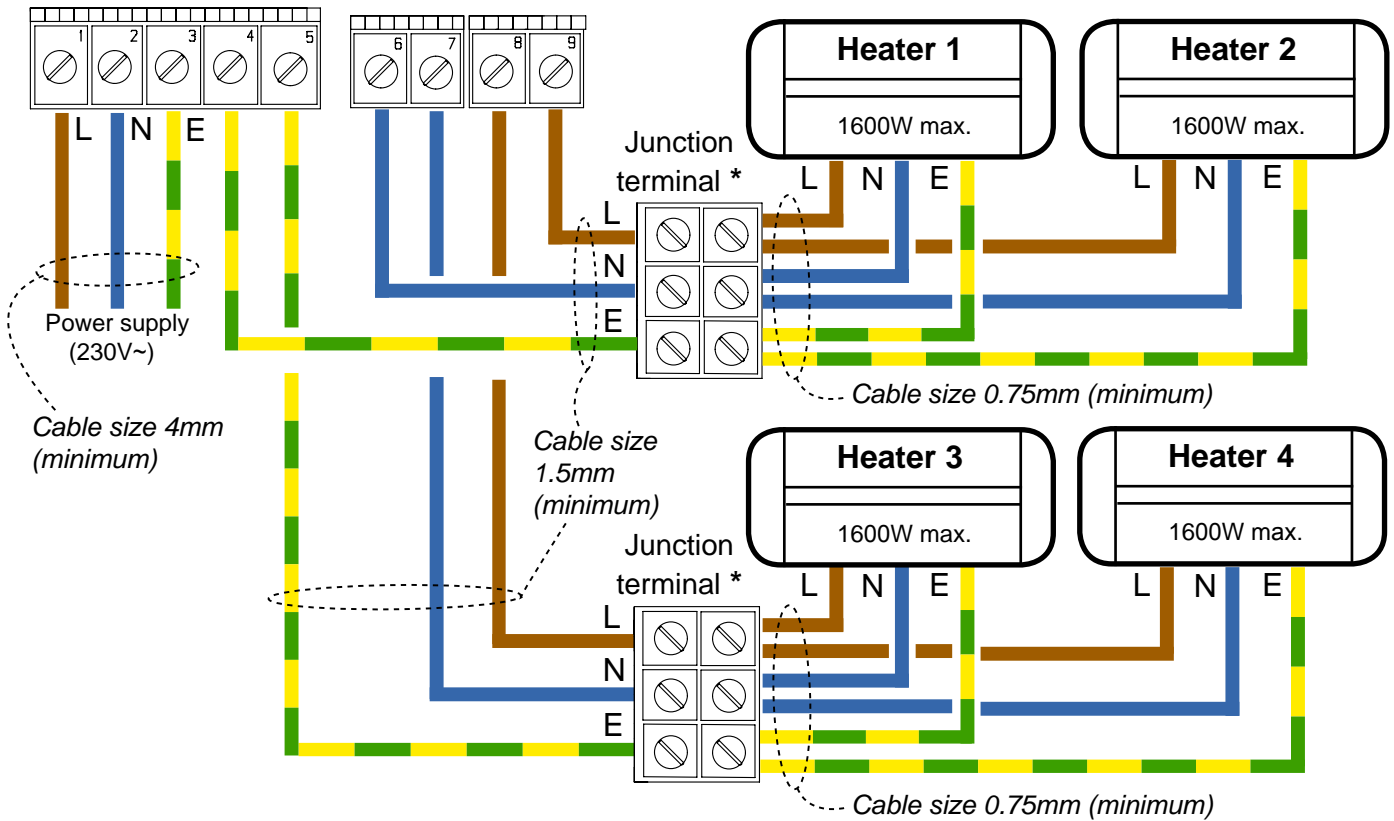

* = junction terminals must comply to safety standards according to the electrical characteristics of the system.

Memorization of a 7 channels transmitter

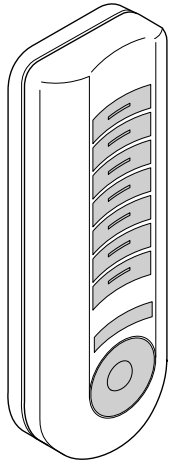

CH1 100 %
CH2 75 %
CH3 50 %
CH4 Min
CH5 Dim +
CH6 Dim -
CH7 OFF

Transmitter
configuration

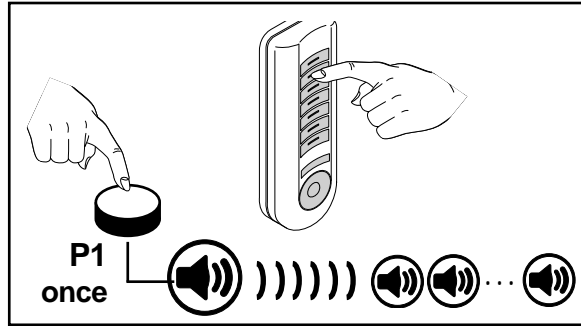

- Press **P1 once** and keep it pressed; the buzzer emits a continuous sound.
- Press any button of transmitter. Once the memorization is successfully completed, the buzzer emits a fast intermittent sound.

Memorization of a 4 channels transmitter (TANREM)

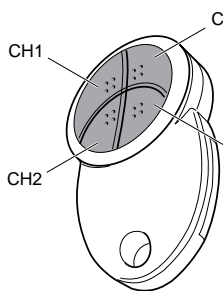

CH1
CH2
CH3
CH4
CH1 100 %
CH2 75 %
CH3 50 %
CH4 OFF

Transmitter
configuration

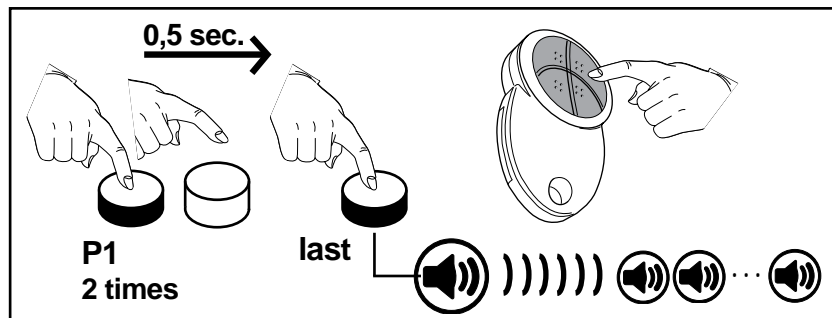

- Press **P1 twice** keeping pressed the **last** time; the buzzer emits a continuous sound.
- Press any button of transmitter. Once the memorization is successfully completed, the buzzer emits a fast intermittent sound.

Memorization of a single channel with On/Off/Dim function

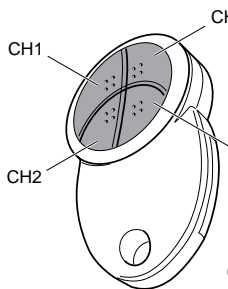

CH1
CH2
CH3
CH4
CH1 Receiver A
CH2 Receiver B
CH3 Receiver C
CH4 Receiver D

Transmitter
configuration

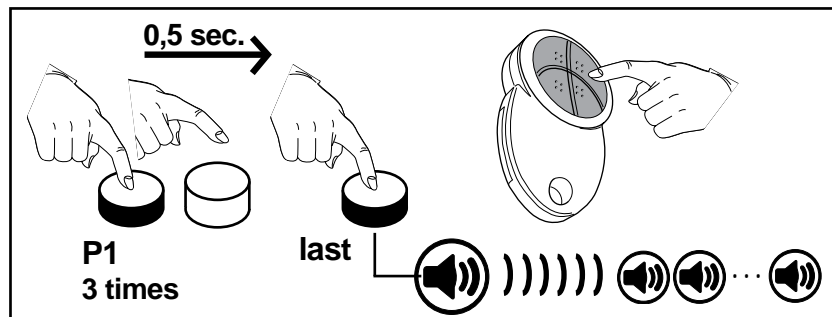

- Press **P1 three times** keeping pressed the **last** time; the buzzer emits a continuous sound.
- Press any button of transmitter. Once the memorization is successfully completed, the buzzer emits a fast intermittent sound.

Note: every single channel of the transmitter can independently command a receiver if properly memorized.

Memorization of movement sensor (TANPIR)

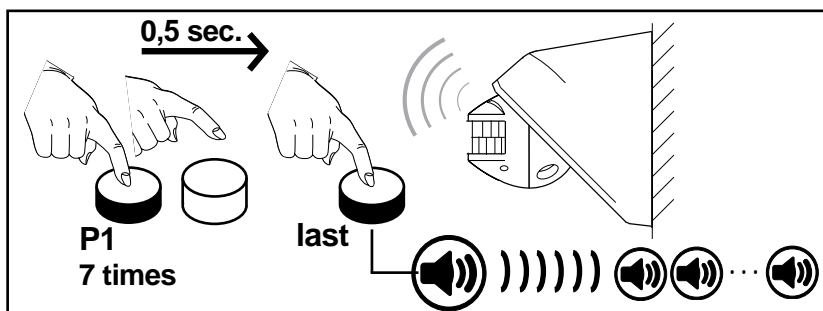

- Press **7 times P1** keeping pressed the **last** time; the buzzer emits a continuous sound.
- Activate the sensor. Once the memorization is successfully completed, the buzzer emits a fast intermittent sound.

Deleting a transmitter

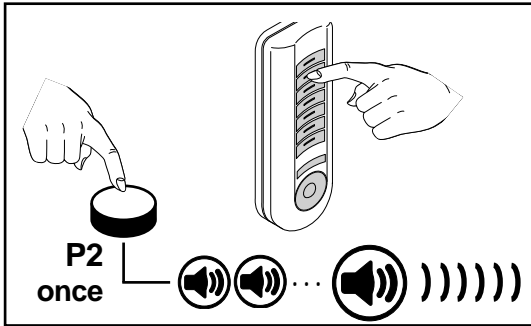

- Press **P2 once** and keep it pressed; the buzzer emits a slow and intermittent sound.
- Press the channel or the transmitter to delete. Once the deletion is successfully completed, the buzzer emits a continuous sound.

Deleting all the transmitters

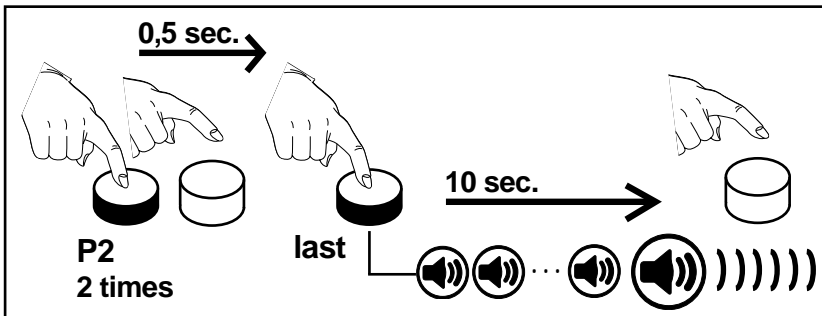

- Press **P2 twice** and keep it pressed for 10 seconds; the buzzer emits a quick and intermittent sound.
- Once the deletion is successfully completed, the buzzer emits a continuous sound.

Activation/Deactivation of the Last Value Memory

When the Memory function is activated, controlling the load in ON/OFF mode, the dimmer will turn-on the load with the same value it had before turning-off.

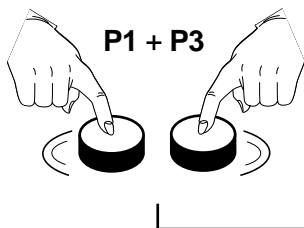

Press the buttons **P1 and P3 at the same time** and keep them pressed.



1 beep: the function is activated.



2 beeps: the function is deactivated.

Warning



The subject appliance must be installed only by qualified technical personnel in compliance with the standards, in an aired place and fixed in vertical position, in contact with material which cannot be damaged by high temperatures.

The connecting cables of the main power supply and of the loads must have appropriate section and electrical insulation.

The installation must comply with the standards on electrical systems.

In the view of a constant development of their products, the manufacturer reserves the right for changing technical data and features without prior notice.

For further information and safety warnings please refer to the complete instructions manual.